

Bellbridge Primary School Studio Link Building

Architect:
NOW Architecture

Project Address:
**Bellbridge Drive,
Hoppers Crossing VIC 3030**

Project Cost:
\$0.2 m

Occupation Date:
July 2008

Capacity:
150

Year Levels:
P - 6

Bellbridge Primary School is a school designed with a long term enrolment of 450 students. Yet with an enrolment exceeding 600 students for well over a decade, Relocatable Buildings are a fact of life. All other permanent GPC's in the school respond to the new pedagogy and inter-link and cluster around shared studio spaces providing an active vitality for team teaching, flexible connectivity to a range of resources and individual learning programs. Beyond this, psychological and physical comfort and learning is supported by spaces with shaded north windows, cross ventilation, high natural light levels and air-locked spaces to provide more even temperature and air quality.

This was not so for three stranded '5 Mod' Relocatable classroom buildings to the NE of the site. Two are side by side facing north and one set approximately 5.5 metres behind on the south. These six general learning classrooms were accessed by a low grim space particularly roofed by a standard covered way that funnelled bleak west winds down the tunnel-like space between. Scraggy shrubs refused to thrive and echoed the diminished potential for teachers to engage with each other, and their students.

The school was passionate about reducing the real disadvantage endured by the students and staff who were forced to operate in these GPC's. The contrast to the opportunities the rest of the

school now enjoy in the new permanent GPC's was stark. The school were funding the project themselves.

NOWarchitecture had a challenge: Develop a solution at the cheapest possible cost, that was independently structured to the three '5 Mod' Relocatable classroom buildings which were at three different floor levels and link them to create a sense of joyful shared entry and shared endeavour. The original dark low alley to each '5 Mod' isolated the Teachers and students into paired groups. The new studio is a series of oblique portals which soars up to collect northern sun and southern light and exhaust stale/over hot air.

Supporting the transformation and unification of the '5 Mods', each '5 Mod' was refurbished with new two-way storage units to provide flexible, convenient access to resources. The link Studio has new wet areas and paved links to the bike area, WC's and other learning zones around the school. At \$145,000 for 180m2, for new studio space plus GPC joinery and link paving, this equates to less than \$800m2. The school community are delighted with the outcome.

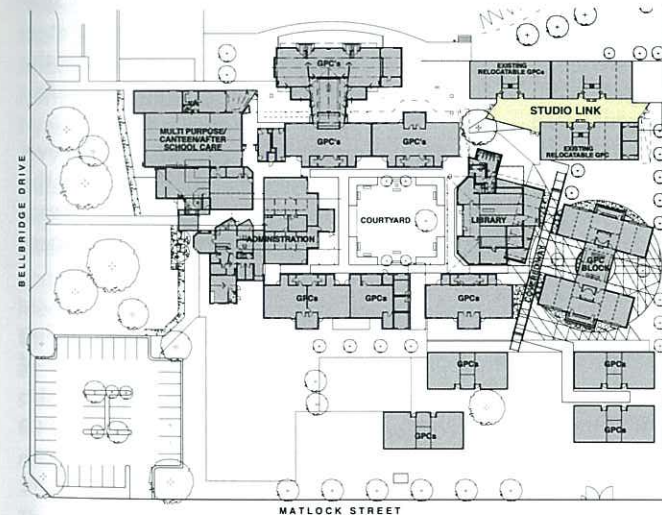

site plan

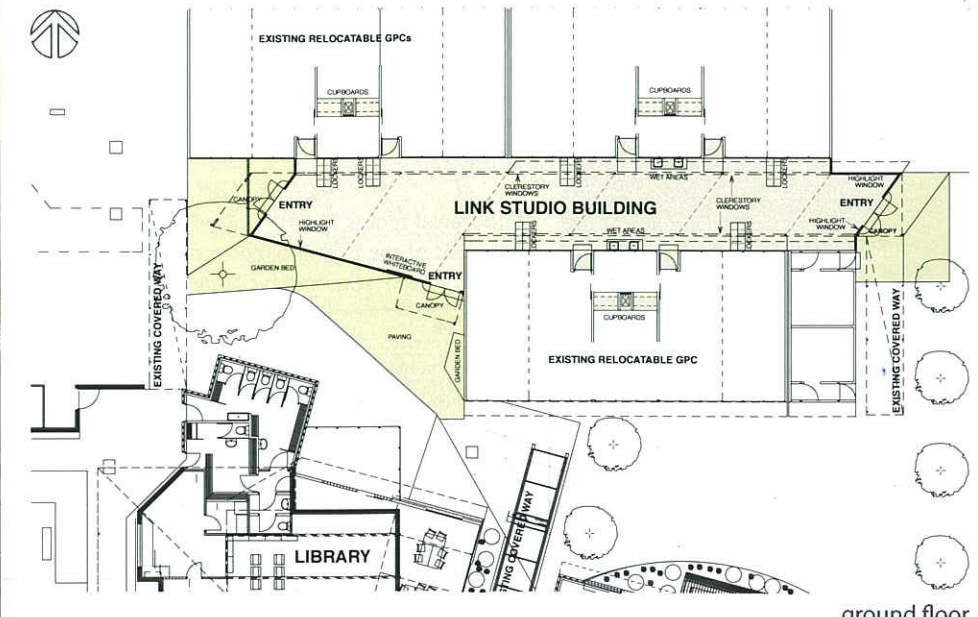
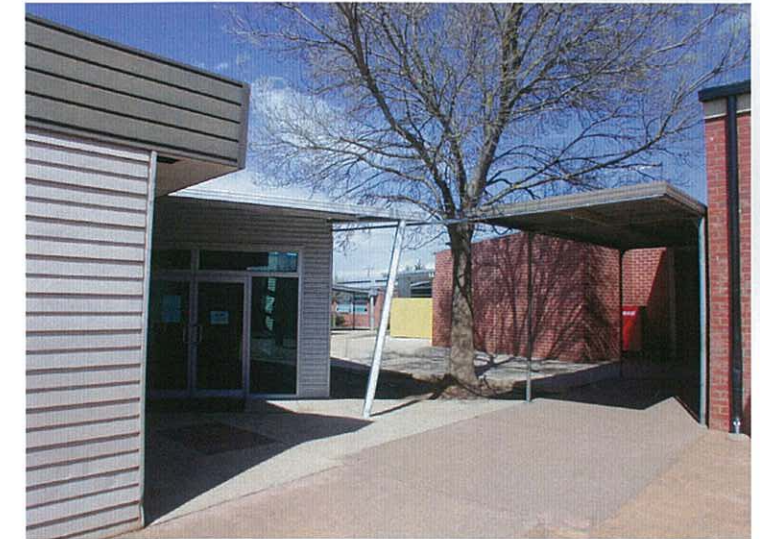

ground floor